

Ship.	Code	Designation
J+5	1080111	FF 1/2" STAINLESS STEEL BRAIDED HOSE 60CM LG
J+5	1090704	10 X NUTS 1/2 GZ
J+5	1090726	20 X RUBBER
J+5	1090806	BAG OF 10 WASHERS 18,6X6X6
⇒	1090853	VALVE SEAL LAC 5 (X5) BLISTER PACK
⇒	1090857	PLUG LAC 5 (X5) BLISTER PACK
⇒	1090868	2 SMALL PIN BLISTER PACK
⇒	1090873	DRAIN PLUG THERMOLAC BLISTER PACK
⇒	1090875	VALVE UNDERPART F 30 BLISTER PACK
⇒	1090882	VALVE SEAL F 30 (X5) BLISTER PACK
⇒	1090920	COMPLETE VALVE F20/FORSTAL BLISTER PACK
⇒	1090922	3 ADJUSTMENT SCREWS FORSTAL BLISTER PACK
⇒	1090923	5 SPRING F30/60/FORSTAL BLISTER PACK
⇒	1090925	5 O RING BLISTER PACK
⇒	1090945	5 X NYLON WASHER 24X18 F11 (BLISTER)
⇒	1090950	2 NEW COMPLETE LED GREEN LIGHT 24V (BLISTER)
⇒	1090959	VALVE BODY LAKCHO-BLISTER
⇒	1090960	VALVE SCHAFT F30/60/110-BLISTER
⇒	1090992	BLISTER WITH 1 FLOAT FOR BIGCHO 2/LAC 10
J+5	1091041	BAG WITH 10 STAINLESS STEEL BLIND NUTS H5
J+5	1091043	2 PLASTIC PUSH RODS F30/FORSTAL
J+5	1091061	10 STAINLESS STEEL FILTERS FOR BABYLAB
J+5	1091065	BAG WITH 2 FLAT RUBBER 29X20X2 STALL 3000
J+5	1091093	BAGS OF 10 STAINLESS STEEL SCREWS Ø6X20
J+5	1190812	PLUG 1"1/4 FOR NORMANDY - BACK
J+5	1190813	BLACK PLUG NORMANDY
J+1	1290120	ASSEMBLING-ADJUSTMENT SCREW-BRASS/FORSTAL
J+5	4050891	VALVE SEAT - BRASS
J+5	4050892	BRASS BODY VALVE FORSTAL
J+1	4110384	COMPLETE VALVE ASSEMBLY
J+5	4140261	SS COVER NORMANDY+SCREWS AND SHUTTER
J+5	4141425	STAINLESS STEEL PROTECTION EDGE - NORMANDY
J+5	4180134	STRAIGHT PIPE FITTING FOR NORMANDY
J+5	4220526	PLASTIC JET FOR BIGCHO 2/ LAC10
J+5	4230131	PE COVER + SCREWS FOR NORMANDY
J+1	4240127	HEATING ELEMENT 80W + INDICATOR WIRES + CONNECTORS
J+5	4380675	BARE BOWL NORMANDY

NORMANDY

Ref. 1716 - 1717

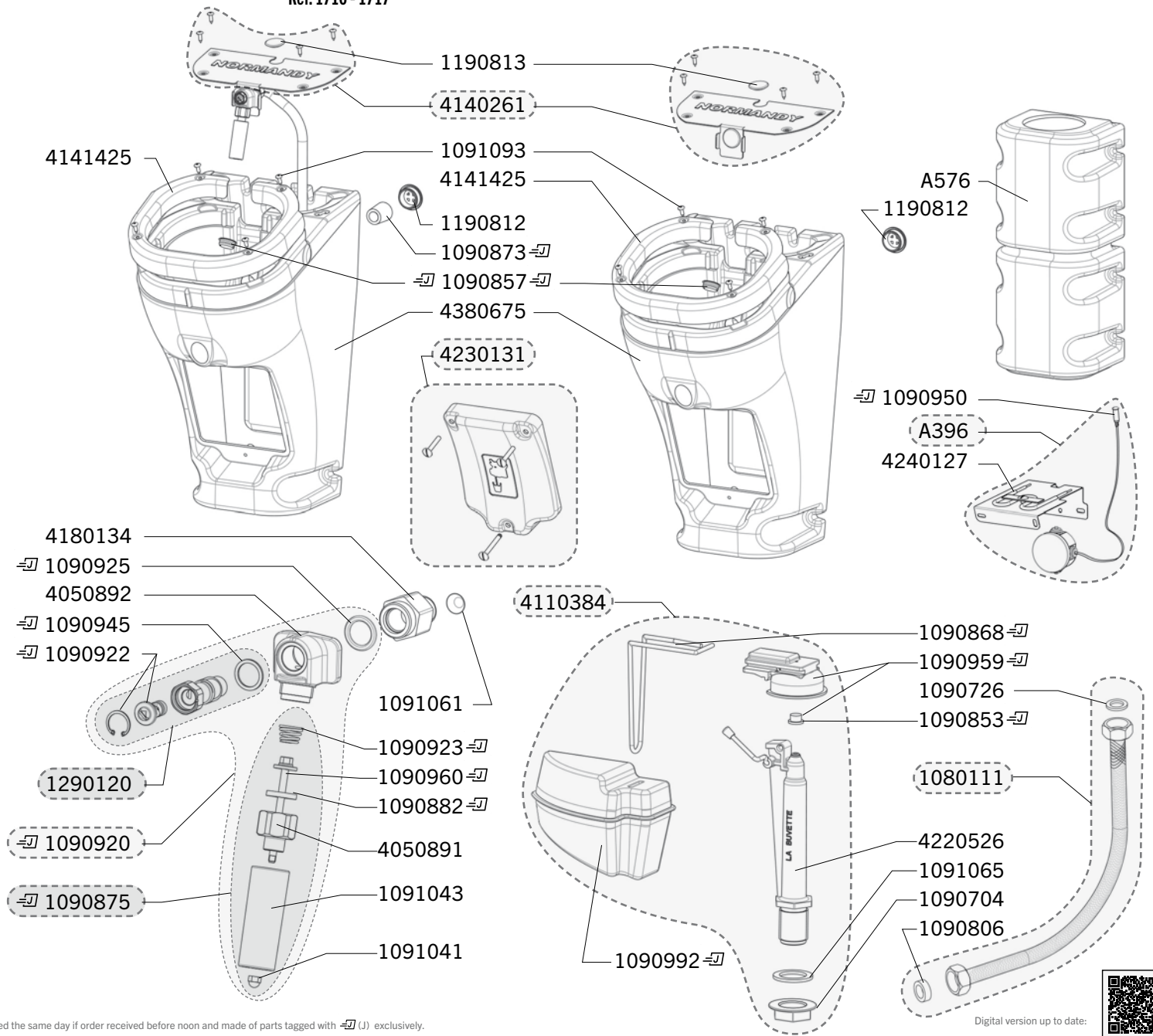

Shipping time in working days (running out of stock excepted), spare parts tagged with a ⇒ (J) are dispatched the same day if order received before noon and made of parts tagged with ⇒ (J) exclusively.

Digital version up to date:

