

# F30 - F30A

Ref. 3051 - 3053 - 3071 - 3275 - 3290 - 3292 - 3294 - 3295 - 3296 - 3297

Ship.	Code	Designation
⇒	1090857	PLUG LAC 5 (X5) BLISTER PACK
⇒	1090875	VALVE UNDERPART F 30 BLISTER PACK
⇒	1090881	FLOW ADJUSTMENT SCREW F 30 (X3) BLISTER PACK
⇒	1090882	VALVE SEAL F 30 (X5) BLISTER PACK
⇒	1090923	5 SPRING F30/60/FORSTAL BLISTER PACK
⇒	1090924	COMPLETE VALVE FOR F30 BLISTER PACK
⇒	1090925	5 O RING BLISTER PACK
⇒	1090926	3 PLUG/WASHER 1/2 FOR F11 BLISTER PACK
⇒	1090927	3 PLUG/WASHER 3/4 " BLISTER PACK
⇒	1090928	BENT JUNCTION 1/2 GZ BLISTER PACK
⇒	1090929	T CONNECTION 1/2 BRASS FFF BLISTER PACK
⇒	1090930	T CONNECTION FFF 3/4-1/2-3/4 BRASS BLISTER PACK
⇒	1090931	5 FILTERS F30/60 BLISTER PACK
⇒	1090933	3 FIXING NUTS FOR ADJUSTEMENT SCREW BLISTER PACK
⇒	1090939	3 FLOW ADJUSTMENT SCREWS F30/60 BEFORE 2004 BLISTER
⇒	1090960	VALVE SCHAFT F30/60/110-BLISTER
⇒	1090984	VALVE HEAD+MOUNTED ADJUSTMENT SCREW BLISTER PACK
⇒	1090991	BLISTER WITH 1 3/4" STAINLESS STEEL T-FITTING
J+5	1091022	BAG WITH 10 BLIND NUTS H8
J+5	1091033	5 STAINLESS STEEL PLUGS
J+5	1091041	BAG WITH 10 STAINLESS STEEL BLIND NUTS H5
J+5	1091043	2 PLASTIC PUSH RODS F30/FORSTAL
J+5	1091045	BAG WITH 10 STAINLESS 6X12 STEEL SCREWS
J+5	2140305	SCREW TH 8X25 SSTEEL
J+5	4021412	ADHESIVE SEAL 6X4X900 F 60
J+5	4050891	VALVE SEAT - BRASS
J+5	4050902	UNDER PART OF THE VALVE STAINLESS STEEL
J+5	4050913	STAINLESS STEEL BODY VALVE
J+5	4050952	COMPLETE VALVE F30 STAINLESS STEEL
J+5	4050953	VALVE UNDEPART F30 STAINLESS STEEL
J+5	4131549	BOWL F30 POLYCOAT
J+5	4131566	F30A BOWL POLYCOAT
J+5	4141421	NO SPILL FRAME WITH SEAL - F30/LAC 5

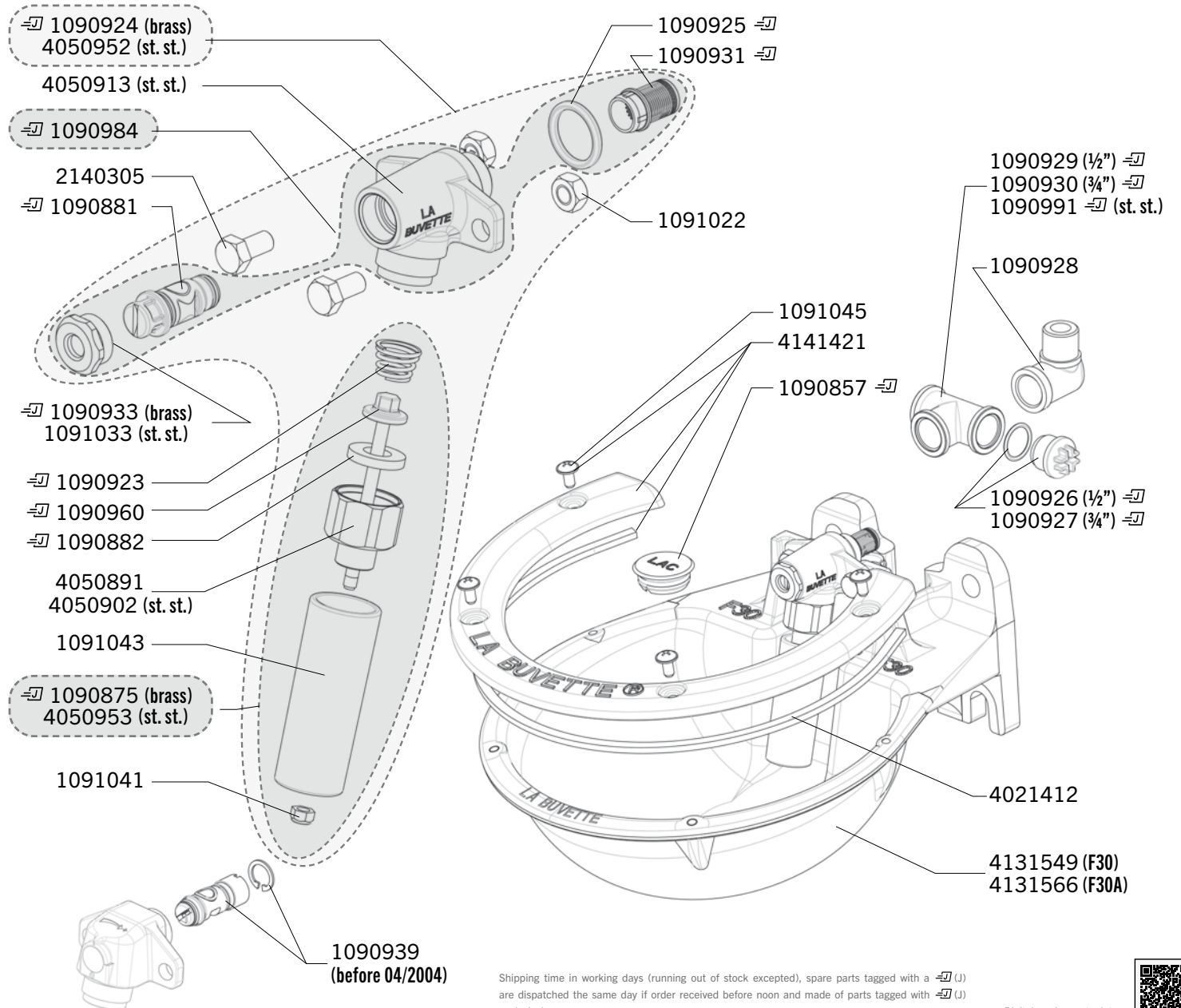

Shipping time in working days (running out of stock excepted), spare parts tagged with a ⇒ (J) are dispatched the same day if order received before noon and made of parts tagged with ⇒ (J) exclusively.

Digital version up to date:

