

F11 - FORSTAL WITH PADDLE

Ref. 3001 - 3002 - 3003 - 3004 - 3005 - 3006 - 3007 - 3008 - 3009 - 3021 - 3022 - 3023 - 3024 - 3025 - 3026 - 3027

Ship.	Code	Designation
J+5	1090705	10 X BRASS NUTS 3/4 GZ
J+5	1090707	10 X BRASS LOCK NUT F11
J+5	1090712	10 X NYLON WASHER 3/4
J+5	1090715	VERY LOW PRESSURE VALVE "0" F11
J+5	1090738	10 X STAINLESSSTEEL PIN
J+1	1090757	10 X PLASTIC FILTER
-J	1090855	DEFLECTOR F 11 (X5) BLISTER PACK
-J	1090856	5 ORIGINAL SPRINKLERS (RED) +FILTERS
-J	1090858	SPRING F 11/FORSTAL (X5) BLISTER PACK
-J	1090859	VALVE "H" (X5) BLISTER PACK +FILTERS
-J	1090877	RENOVATION KIT TAP "S" OR "H" ALL VERSIONS
-J	1090926	3 PLUG/WASHER 1/2 FOR F11 BLISTER PACK
-J	1090927	3 PLUG/WASHER 3/4 " BLISTER PACK
-J	1090945	5 X NYLON WASHER 24X18 F11 (BLISTER)
-J	1090946	3 X VALVE SEAT F11 (BLISTER)
-J	1090951	1 PLASTIC PADDLE F11-BLISTER
-J	1090952	VERTICAL PLASTIC PADDLE F11-BLISTER
-J	1090977	BLISTER WITH 3/4" ELBOW F11/FORSTAL WITH PADDLE
-J	1090978	BLISTER WITH 3/4" T-FITTING F11/FORSTAL PADDLE
J+5	1290115	STAINLESS STEEL PADDLE F11
J+5	4131528	F11 BOWL F11
J+5	4131531	BOWL FOR FORSTAL WITH PADDLE
J+5	4180414	BENT BODY 3/4 NPT
J+5	4650205	COMPLETE VALVE "0" - ST.STEEL PADDLE F11
J+1	4680102	PADDLE STOP

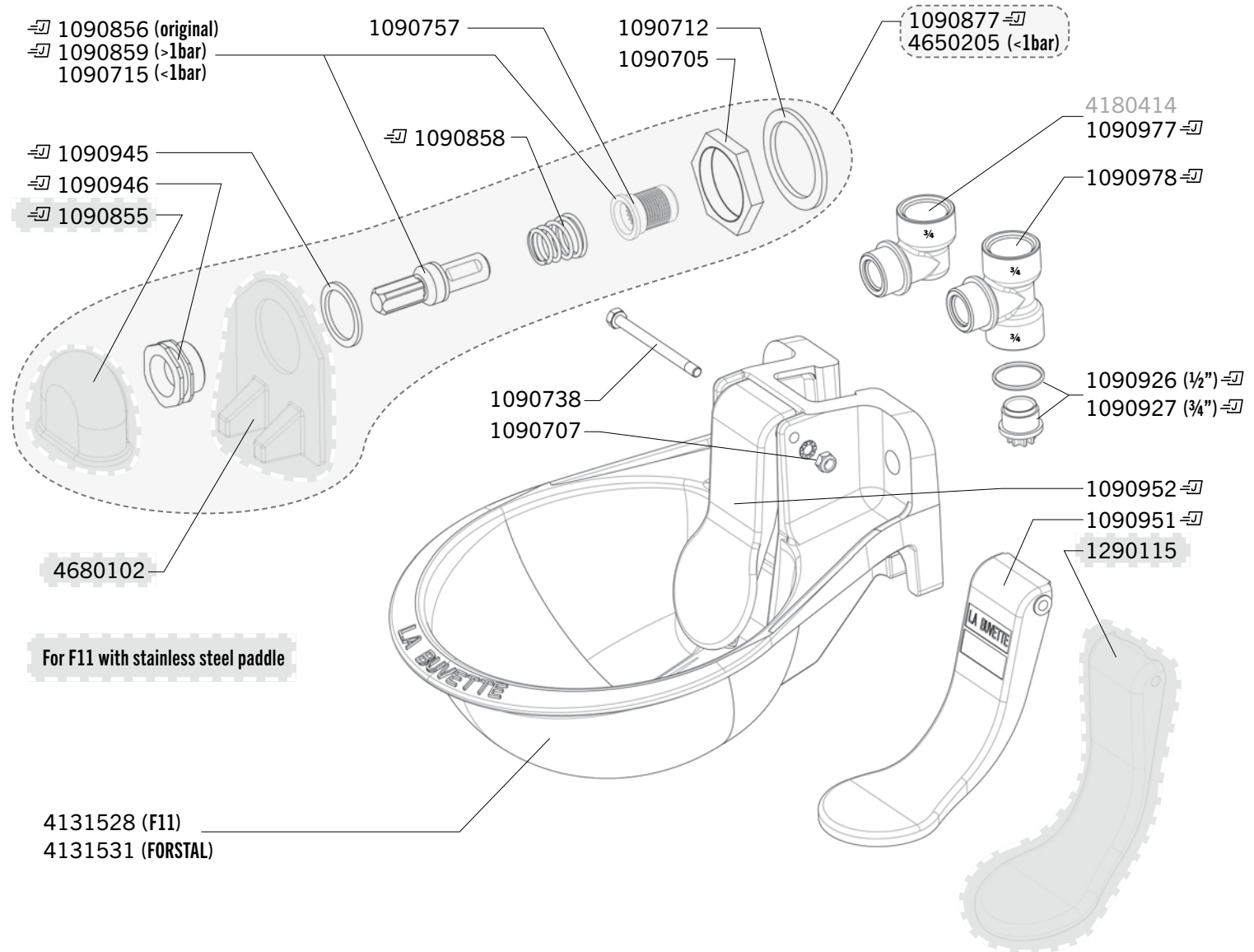

Shipping time in working days (running out of stock excepted), spare parts tagged with a -J (J) are dispatched the same day if order received before noon and made of parts tagged with -J (J) exclusively.

Digital version up to date:

